

# Model CC-S

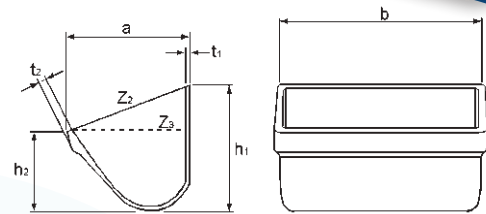

The CC-S type is a high-capacity elevator bucket. This bucket, with its extra-thick walls, is exceptionally durable. Available in HDPE and Nylon versions.



CC-S elevator buckets (parameters in mm )

Type	Size/weight	Size/weight						Volume (L)		Max. bckts/m	
		b	a	h1	h2	t	t2	Kg	Z2		Z3
CC-S	3x2	85	64	53	35	4,5	6,0	0,05	0,15	0,11	15,75
CC-S	4x3	112	89	78	54	5,0	7,0	0,11	0,39	0,31	11,25
CC-S	5x4	135	115	103	72	5,0	7,5	0,20	0,80	0,58	8,75
CC-S	6x4	161	115	103	72	5,0	7,5	0,23	0,96	0,74	8,75
CC-S	7x4	186	115	103	72	5,0	7,5	0,26	1,13	0,87	8,75
CC-S	6x5	163	141	131	93	6,0	10,5	0,37	1,48	1,15	7,15
CC-S	7x5	189	141	131	93	6,0	10,5	0,41	1,74	1,35	7,15
CC-S	8x5	214	141	131	93	6,0	10,5	0,45	2,00	1,56	7,15
CC-S	9x5	240	141	131	93	6,0	10,5	0,50	2,22	1,71	7,15
CC-S	10x5	265	141	131	93	6,0	10,5	0,54	2,53	1,97	7,15
CC-S	11x5	290	141	131	93	6,0	10,5	0,59	2,78	2,17	7,15
CC-S	12x5	316	141	131	93	6,0	10,5	0,62	3,05	2,38	7,15
CC-S	8x6	213	169	154	109	6,0	12,5	0,56	2,76	2,10	6,00
CC-S	9x6	239	169	154	109	6,0	12,5	0,64	2,95	2,35	6,00
CC-S	10x6	264	169	154	109	6,0	12,5	0,68	3,38	2,75	6,00
CC-S	11x6	289	169	154	109	6,0	12,5	0,72	3,85	3,10	6,00
CC-S	12x6	315	169	154	109	6,0	12,5	0,78	4,30	3,30	6,00
CC-S	13x6	340	169	154	109	6,0	12,5	0,84	4,60	3,60	6,00
CC-S	14x6	365	169	154	109	6,0	12,5	0,90	5,05	3,95	6,00
CC-S	10x7	273	200	180	127	8,0	14,0	1,05	5,12	3,96	5,25
CC-S	11x7	299	200	180	127	8,0	14,0	1,10	5,50	4,30	5,15
CC-S	12x7	324	200	180	127	8,0	14,0	1,20	6,18	4,79	5,25
CC-S	13x7	350	200	180	127	8,0	14,0	1,28	6,71	5,20	5,25
CC-S	14x7	375	200	180	127	8,0	14,0	1,37	7,25	5,62	5,25
CC-S	15x7	400	200	180	127	8,6	14,0	1,45	7,76	6,03	5,25
CC-S	16x7	426	200	180	127	8,0	14,0	1,53	8,30	6,44	5,25
CC-S	10x8	275	228	210	149	10,0	15,0	1,44	6,66	5,19	4,60
CC-S	11x8	300	228	210	149	10,0	15,0	1,55	7,35	5,73	4,60
CC-S	12x8	326	228	210	149	10,0	15,0	1,66	8,07	6,29	4,60
CC-S	13x8	351	228	210	149	10,0	15,0	1,76	8,75	6,83	4,60
CC-S	14x8	377	228	210	149	10,0	15,0	1,88	9,47	7,40	4,60
CC-S	15x8	402	228	210	149	10,0	15,0	1,97	10,16	7,94	4,60
CC-S	16x8	427	228	210	149	10,0	15,0	2,05	10,85	8,48	4,60
CC-S	18x8	479	228	210	149	10,0	15,0	2,30	12,28	9,61	4,60
CC-S	20x8	529	228	210	149	10,0	15,0	2,50	13,65	10,70	4,60

Z2 = gross volume in liters, Z3 = net volume in liters.

These elevator buckets have no holes, but those may be drilled according to the client's specifications.